

# Cervical Screening Test Collection Guide

## Thinprep Instructions for Cervix-Brush protocol.

- Prepare all equipment before starting the procedure.
- Note expiry date on sample collection vial. Do not use expired vials.
- Ensure the entire plastic seal is removed from the lid of the vial and discarded.

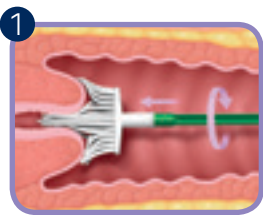

**Obtain** an adequate sample by inserting the central bristles of the brush into the endocervical canal deep enough to allow the shorter bristles to fully contact the ectocervix. Push gently, and rotate the brush 360° in a clockwise direction 5 times. The use of lubricants may interfere with pathology tests. If necessary use a small amount of water-soluble carbomer-free lubricant applied sparingly to the outer portion of the speculum only, avoiding the tip. Lubricant supplied by SydPath is water soluble and carbomer-free.



**Vigorously Rinse** the Cervix-Brush immediately into the Thinprep vial by pushing it into the bottom of the vial 10 times, forcing the bristles apart. **Do not leave the head of the Cervix-Brush in the vial.**



**Tighten** the cap so that the torque line on the cap passes the torque line on the vial. **Do not over-tighten.**



**Label** the Thinprep with the patient's given name, surname, and date of birth. Complete patient details and clinical history and complete the Cervical Screening Status on the SydPath pathology request form. Place vial and request form in a specimen bag for transportation to the laboratory.

# Thinprep Instructions for Cytobrush and Spatula protocol

- Prepare all equipment before starting the procedure.
- Note expiry date on sample collection vial. Do not use expired vials.
- Ensure the entire plastic seal is removed from the lid of the vial and discarded.

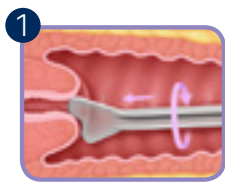

**Obtain** an adequate sample from the ectocervix using a Spatula. Select the contoured end of the plastic spatula and rotate it 360° in a clockwise direction around the entire ectocervix, while maintaining tight contact with ectocervical surface. The use of lubricants may interfere with pathology tests. If necessary use a small amount of water-soluble carbomer-free lubricant applied sparingly to the outer portion of the speculum only, avoiding the tip. Lubricant supplied by SydPath is water soluble and carbomer-free.



**Rinse** the Spatula immediately into the Thinprep vial by swirling the spatula **vigorously** in the vial 10 times. Discard the Spatula.

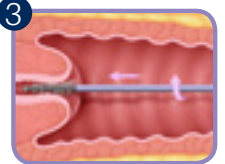

**Obtain** an adequate sampling from the endocervix using a cytobrush device. Insert the cytobrush into the endocervical canal until only the bottom-most fibers are exposed. Slowly rotate 1/4 or 1/2 turn in one direction. **Do not over-rotate the brush.**



**Rinse** the cytobrush immediately into the same Thinprep vial by rotating the device in the solution 10 times while pushing against the vial wall. Then swirl the brush **vigorously** to further release the material. Discard the brush.



**Tighten** the cap so that the torque line on the cap passes the torque line on the vial. **Do not over-tighten.**



**Label** the ThinPrep with the patient's given name, surname, and date of birth. Complete patient details and clinical history and complete the Cervical Screening Status on the SydPath pathology request form. Place vial and request form in a specimen bag for transportation to the laboratory.